

Soils Map

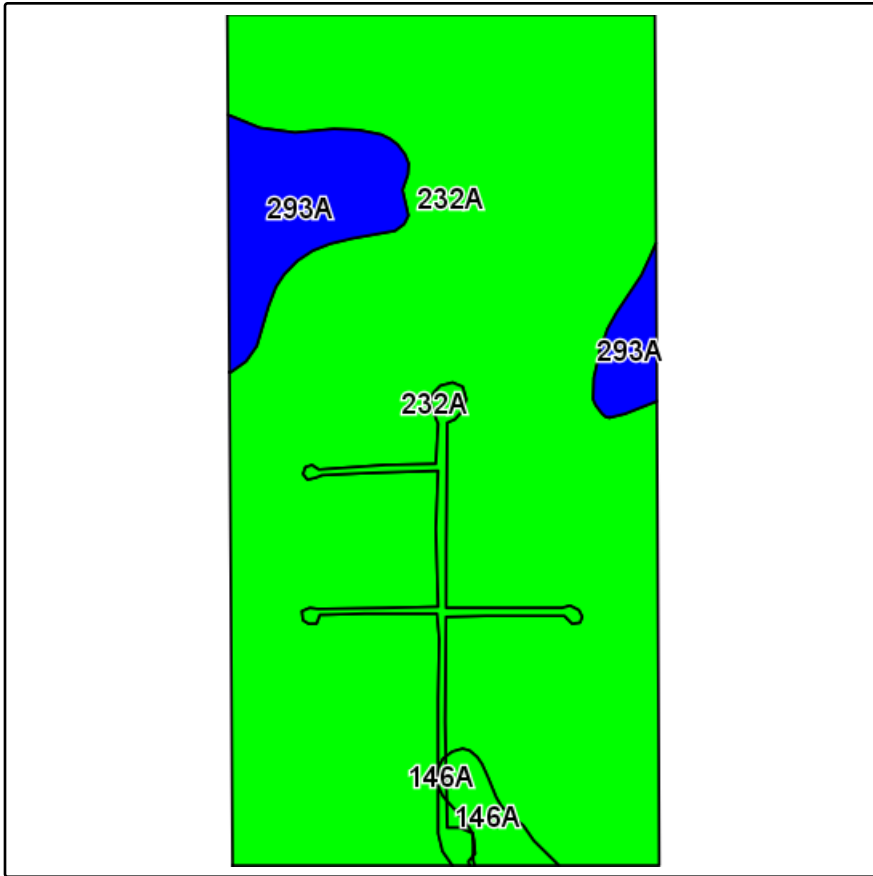

Field borders provided by Farm Service Agency as of 5/21/2008.
Soils data provided by University of Illinois at Champaign-Urbana.

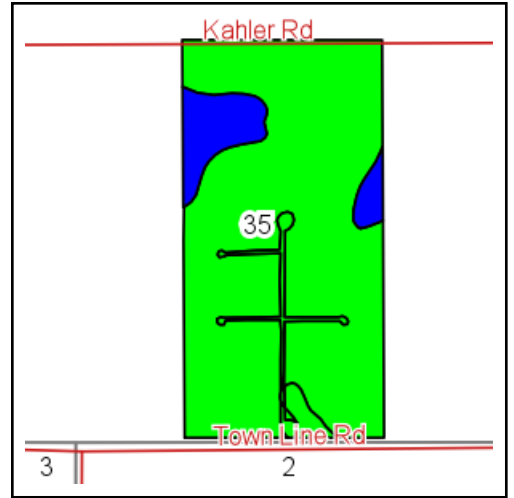

State: **Illinois**
County: **Will**
Location: **35-33N-10E**
Township: **Florence**
Acres: **79.47**
Date: **9/30/2013**

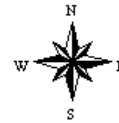

Maps provided by:



| Code | Soil Description | Acres | Percent of field | Ill. State Productivity Index Legend | Corn Bu/A | Soybeans Bu/A | Crop productivity index for optimum management |
|-------------------------|---|-------|------------------|--------------------------------------|--------------|---------------|--|
| 232A | Ashkum silty clay loam, 0 to 2 percent slopes | 71.17 | 89.6% | | 170 | 56 | 127 |
| 293A | Andres silt loam, 0 to 2 percent slopes | 6.94 | 8.7% | | 184 | 59 | 135 |
| 146A | Elliott silt loam, 0 to 2 percent slopes | 1.36 | 1.7% | | 168 | 55 | 125 |
| Weighted Average | | | | | 171.2 | 56.2 | 127.7 |

Table: Optimum Crop Productivity Ratings for Illinois Soil by K.R. Olson and J.M. Lang, Office of Research, ACES, University of Illinois at Champaign-Urbana. Version: 1/2/2012 Amended Table S2 B811 (Updated 1/10/2012)
Crop yields and productivity indices for optimum management (B811) are maintained at the following NRES web site: <http://soilproductivity.nres.illinois.edu/>
** Indexes adjusted for slope and erosion according to Bulletin 811 Table S3