

Soils Map

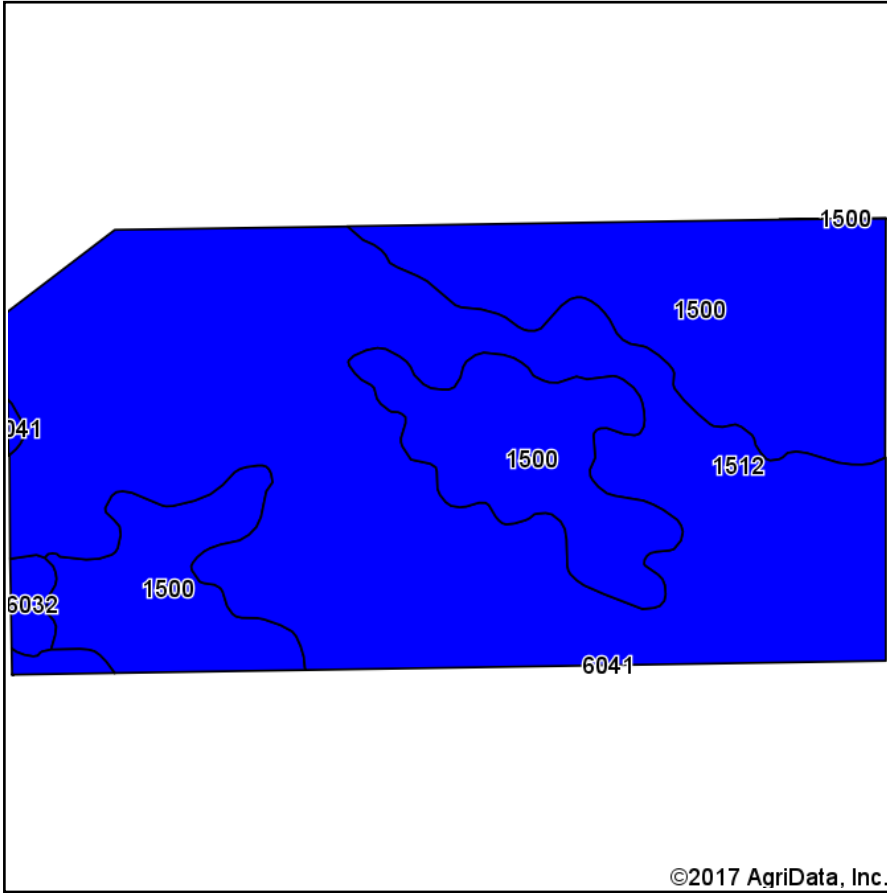

Soils data provided by USDA and NRCS.

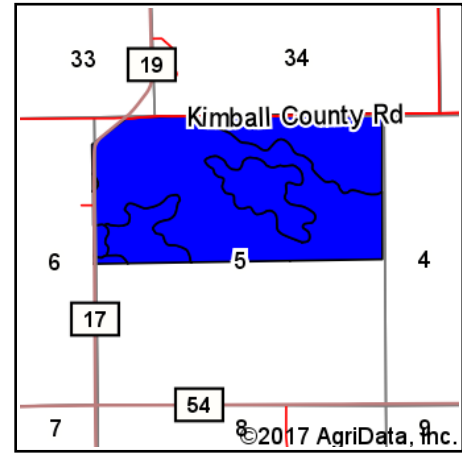

State: **Nebraska**
 County: **Kimball**
 Location: **5-16N-57W**
 Township: **Bushnell**
 Acres: **317.38**
 Date: **7/20/2017**

Maps Provided By:



© AgriData, Inc. 2017

www.AgriDataInc.com



Area Symbol: NE007, Soil Area Version: 22
 Area Symbol: NE105, Soil Area Version: 16

Code	Soil Description	Acres	Percent of field	SRPG Legend	Non-Irr Class *c	Irr Class *c	SRPG
1512	Altvan-Satanta loams, 0 to 1 percent slopes	195.27	61.5%		IIIc	IIs	46
1500	Altvan fine sandy loam, 1 to 3 percent slopes	118.35	37.3%		IIIe	IIIe	44
6032	Tassel-Blanche complex, 9 to 30 percent slopes	3.29	1.0%		VIIs		14
6041	Tassel-Blanche sandy loams, 3 to 9 percent slopes	0.47	0.1%		VIe		16
Weighted Average							44.9

*c: Using Capabilities Class Dominant Condition Aggregation Method

Soils data provided by USDA and NRCS.